

# Turning Great Ideas into Great Projects

## Architectural, Civil & Structural - Typical Documents

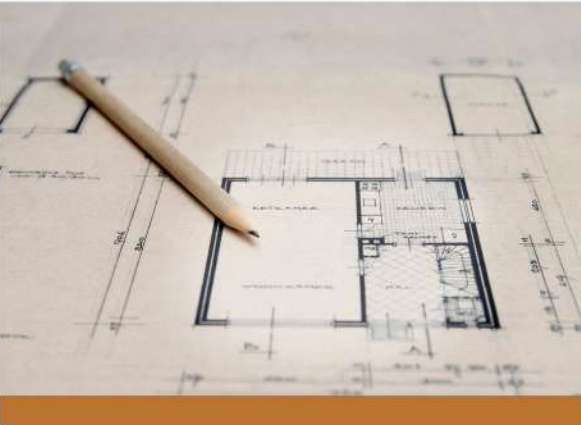

- Site Development & Grading Plan
- BIM 360 Model Design incl. Architecture, Structure, MEP,
- Building Architectural Views
- Building Floor Plans
- Lighting Location Plan
- Small Power Location Plan
- Sanitary & Amenities Location Plan
- Parking & Access Plans
- HVAC Load Calculation Report
- Standard Drawings: Foundations (Structures, Static Equipment, Rotary Equipment)
- Standard Drawings: Roads, Paving, Trenches, Culverts
- Standard Drawings: Elevated & Underground Tanks
- Standard Drawings: Drainage Collection & Disposal (Storm, Sanitary Sewers, Effluent)
- Standard Drawings: Effluent Ponds, Containment
- Standard Drawings: Steel Structure (Primary)
- Standard Drawings: Steel Structure (Secondary, Handrails, Staircases, Platforms)
- Standard Drawings: Concrete Structures
- Standard Drawings: Lifting & Overhead Cranes
- Standard Drawings: Retaining Walls, Dykes, Trenches
- Standard Drawings: Pipe Racks, Pipe Supports, Stanchions
- Standard Drawings: Buildings, Civils, Fence, Gates
- Information Drawings

**ATH-Præzis is able to offer quality engineering work demonstrated through engineering documentation. Typically, the documents prepared by engineers, designers and draftsmen fall in the headings given here. Actual document nomenclature of engineering and design documents varies; ATH-Præzis takes care to employ Client's document protocols for each awarded project.**

*For Buildings, the documentation covers MEP, HVAC and BMS to co the architectural, structural and civil engineering. For industry, oil & gas, petrochemicals, drawings are prepared also for pigging systems, chemical injection skids. Engineering work covers towers, flare Stacks, and chimneys. For energy sector, engineering and design includes sub-stations, transmission and distribution lines. ATH-Præzis is also able to offer design for process control system, fire detection and protection systems, emergency shutdown system, modulating systems, Communications & Data Communications*

Partner for **Perfect Advantage**

For more information, please contact your local ATH-Præzis representative or visit:  
[www.ath-praezis.com](http://www.ath-praezis.com)